



## Stainless Steel Pop-Off Valves

### Standard Models

**9960, 9961  
9962**

### High Temperature Models

**9960S, 9961S  
9962S**

### FEATURES

- Special hardened stainless steel seat and acetal needle valve or a high temperature version stainless steel seat and needle valve eliminates weeping.
- Lightweight, compact design quickly and conveniently mounts directly into discharge line.
- Provides back-up protection as a secondary relief valve to assure complete pressure relief for maximum pump and system protection.

### SPECIFICATIONS

|                             | U.S. Measure  | Metric Measure |
|-----------------------------|---------------|----------------|
| <b>MODELS 9960, 9960S</b>   |               |                |
| System Pressure Range ..... | 300-1500 psi  | (20-105 bar)   |
| Inlet Port .....            | 1/4" NPTM     | (1/4" NPTM)    |
| <b>MODELS 9961, 9961S</b>   |               |                |
| System Pressure Range ..... | 1000-3000 psi | (70-210 bar)   |
| Inlet Port .....            | 1/4" NPTM     | (1/4" NPTM)    |
| <b>MODELS 9962, 9962S</b>   |               |                |
| System Pressure Range ..... | 1000-4000 psi | (70-275 bar)   |
| Inlet Port .....            | 1/4" NPTM     | (1/4" NPTM)    |

### COMMON SPECIFICATIONS

|                                  |               |              |
|----------------------------------|---------------|--------------|
| Flow Range .....                 | 1-6 gpm       | (3.8-23 lpm) |
| Maximum Operating Temperatures:  |               |              |
| Models 9960, 9961, 9962 .....    | 180°F         | (82°C)       |
| Models 9960S, 9961S, 9962S ..... | 240°F         | (116°C)      |
| Barb .....                       | 3/4"          | (3/4")       |
| Weight .....                     | 2.79 oz.      | (.08 kg)     |
| Dimensions .....                 | 0.75 x 2.375" | (19 x 60 mm) |

Note: Models with suffix "S" have stainless steel needle valve and seat.

#### ⚠ CAUTIONS AND WARNINGS

All High Pressure Systems require a primary pressure regulating device (i.e. regulator, unloader) and a secondary pressure relief device (i.e. pop-off valve, relief valve). Failure to install such relief devices could result in personal injury or damage to pump or property. CAT PUMPS does not assume any liability or responsibility for the operation of a customer's high pressure system.

Read all CAUTIONS and WARNINGS before commencing service or operation of any high pressure system. The CAUTIONS and WARNINGS are included in each service manual and with each Accessory Data sheet. CAUTIONS and WARNINGS can also be viewed online at [www.catpumps.com/cautions-warnings](http://www.catpumps.com/cautions-warnings) or can be requested directly from CAT PUMPS.

#### WARRANTY

View the Limited Warranty on-line at [www.catpumps.com/warranty](http://www.catpumps.com/warranty).

**SELECTION** Select a pop-off valve to meet or exceed the flow and pressure requirements of the system. The valve with the silver spring covers the 300-1500 psi range, the blue spring covers the 1000-3000 psi range and the red spring covers the 1000-4000 psi range.

**INSTALLATION** The pop-off valve should be mounted in the discharge line before any pressure regulator or unloader in the system to provide optimum protection. The exit flow from the pop-off valve should be returned to a reservoir or drain to the floor, not to the inlet of the pump. Following final pressure adjustment, attach a hose over the barb end of the pop-off valve and commence operation.

**OPERATION** This pop-off valve provides back-up protection to the primary relief valve for complete pressure relief and maximum pump and system protection.

**PRESSURE ADJUSTMENT** Before system is brought up to pressure ensure that the primary pressure regulating device is set at its minimum setting. The adjustment screw is internal on this pop-off valve. Using a 1/4" allen wrench, the pressure setting may be **increased** by turning **clockwise** or **decreased** by turning **counterclockwise**. Adjust the pop-off valve to a high pressure setting by turning the adjustment screw approximately 1/2" from flush. Bring your system up to desired pressure using the primary pressure device. **NOTE: If the pop-off valve relieves water in this process increase its setting.** With your system operating at full pressure with the primary pressure device, slowly back the pop-off adjustment screw until a small amount of water is dripping. Immediately adjust in 1/2 turn at a time until dripping stops; (no more than [3] 1/2 turns should be required). The pop-off valve is now set at approximately 10% over system pressure.

**REMEMBER, THE POP-OFF VALVE IS A SECONDARY SAFETY DEVICE. IT DOES NOT REPLACE A PRESSURE REGULATOR OR UNLOADER.**

## PARTS LIST

| P/N   | MATL | DESCRIPTION                         | QTY |
|-------|------|-------------------------------------|-----|
| 76934 | STB  | Seat                                | 1   |
| 76954 | S    | Retainer, Seat                      | 1   |
| 31128 | D    | Valve, Needle (9960, 9961, 9962)    | 1   |
| 76974 | S    | Valve, Needle (9960S, 9961S, 9962S) | 1   |
| 30956 | S    | Spring, Silver (1500 PSI)           | 1   |
| 30957 | S    | Spring, Blue (3000 PSI)             | 1   |
| 33957 | S    | Spring, Red (4000 PSI)              | 1   |
| —     | SS   | Body - 1/4" NPTM                    | 1   |
| 30959 | BB   | Adjuster, Pressure                  | 1   |

Material Codes (Not Part of Part No.):  
 BB=Brass D=Acetal S=304SS SS=316SS  
 STB=Special Blend PTFE

## TROUBLESHOOTING

|                             |   |
|-----------------------------|---|
| Valve cycles                | <ul style="list-style-type: none"> <li>• Valve is improperly set. Repeat adjustment procedure.</li> </ul> |
| Valve continually by-passes | <ul style="list-style-type: none"> <li>• Seat or needle valve is worn. Replace as needed.</li> </ul>      |

## TYPICAL POP-OFF VALVE INSTALLATION

- 1 Triplex Plunger Pump
- 2 Pressure Gauge
- 3 Pop-off Valve (secondary relief valve)
- 4 Pulsation Dampener
- 5 Pressure Sensitive Regulating Unloader

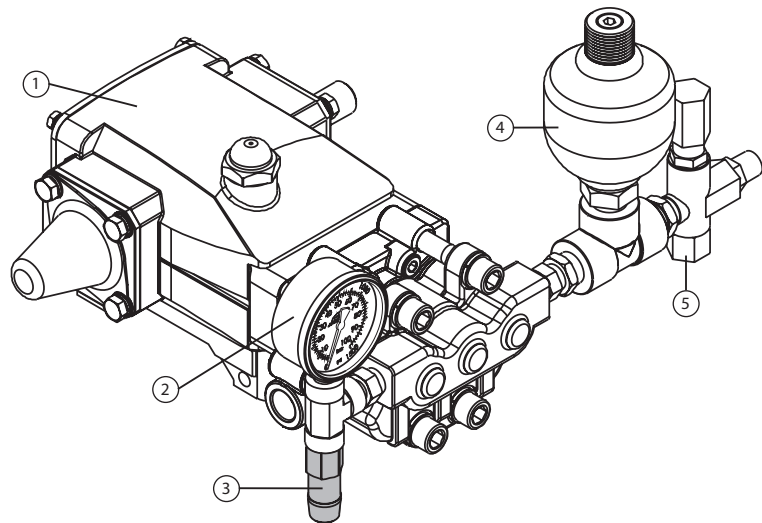

**CAT PUMPS**  
 1681 - 94TH LANE N.E. MINNEAPOLIS, MN 55449-4324  
 PHONE (763) 780-5440 — FAX (763) 780-2958  
 e-mail: techsupport@catpumps.com  
 www.catpumps.com