

Repair Kits

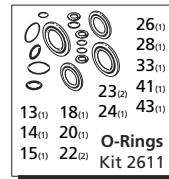
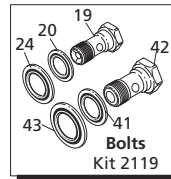
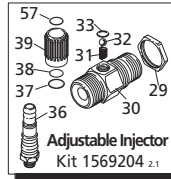
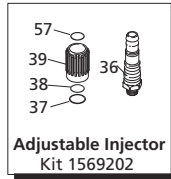

Pos	Code	Description	Qty.	Pos	Code	Description	Qty.	3/B	Legend	3/B+IDR
1	1560580	Handle plug	1	35	1560700	Adaptor - steel 3/8" NPT	● 1	3/B	3/B+ID	3/B+IDR
2	180030	Adjusting screw M8x20	1	35	1560110	Adaptor - brass 3/8" G	● 1	For ●	For ■	For ▲
3	1660210	Lock nut	1	35	1560111	Adaptor - steel 3/8" G	● 1	AR20242	AR20081 1.8	AR20399 1.8
4	1560400	Unloader knob	1	36	1560650	Hose barb (adjustable)	▲ 1		AR20082 2.1	AR20400 2.1
5	1080070	Pin	1	37	800560	O-Ring ø8.73x1.78	▲ 1			
6	1560420	Adjusting cap - brass	1	38	480560	O-Ring ø6.75x1.78	▲ 1			
7	1560410	Spring guide	1	39	1560670	Detergent regulator knob	▲ 1			
8	1560440	Spring plate	1	40	1540020	By-pass housing	1			
9	1560350	Spring	1	41	1540120	Washer ø1/2"	1			
10	1080610	Spring button	1	42	1540090	Inlet bolt	1			
11	1080660	Pin	1	42	1560710	Bolt w 1/8" tap	1			
12	1080540	Upper piston	1	43	1560290	Washer ø1/2"	1			
13	391000	O-Ring ø9.13x2.62	1	44	480440	O-Ring ø17.13x2.62	1			
14	1080640	Back-up ring	1	50	1540050	Inlet fitting 1/2" G	1			
15	1560150	O-Ring ø5.94x3.53	1	50	1560640	Inlet fitting 1/2" G NPT	1			
16	1560100	Shutter valve	1	57	1560660	Ring	▲ 1			
17	1560140	Spring	1							
18	180101	O-Ring ø17.5x2	1							
19	1540080	Mounting bolt 3/8" G	1							
20	1540110	Sealing washer ø3/8"	1							
21	1560010	Valve body	1							
22	1080550	Back-up ring	2							
23	480480	O-Ring ø4.48x1.78	2							
24	1560280	Sealing washer ø3/8"	1							
25	1560320	Lower piston	1							
26	880270	O-Ring ø17.17x1.78	1							
27	1560051	By-pass adaptor	1							
28	390080	O-Ring ø11.91x2.62	1							
29	1560510	Lock nut	▲ 1							
30	1560500	Injector body 3/8" G 1.8	▲ 1							
30	1560530	Injector body 3/8" G 2.1	▲ 1							
31	1560520	Spring	▲ 1							
32	1250280	Ball	▲ 1							
33	480480	O-Ring ø4.48x1.78	▲ 1							
34	1560490	Hose barb (fixed)	■ 1							