

**HN-2003-PROLINE**  
**11-04-03**  
**EFFECTIVE S/N 200302071**

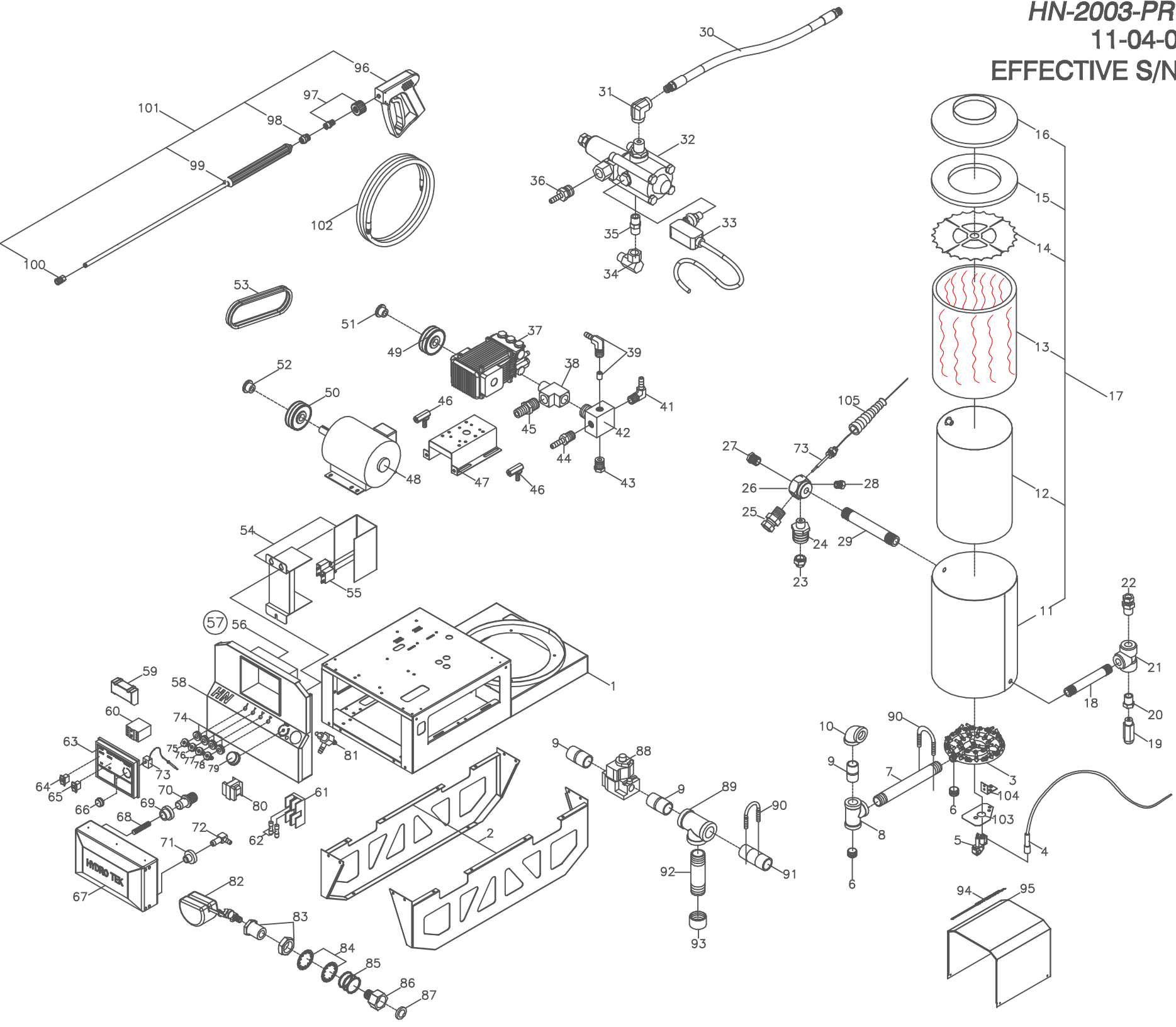

# HN PROLINE PARTS LIST

11-04-03 EFFECTIVE S/N 200302071

1	HNG48	HN FRAME (2003) P COATED	ALL	53	KSB35	BELT BX35	HN30005E3H & E4H
2	HNG36	LEG EXTENTIONS PAIR HN 2003	ALL		KSB4X	BELT BX40	HN20005E2H
3	BGW70	X44 BURNER RING W/JETS NAT GAS	ALL		KSB38	BELT BX38	HN20004E2C
4	BGW36	IGNITION WIRE 47" NG/HN ASM	ALL	54	ECT05	TRANSFORMER 460/230V 100VA BOX	HN30005E4H
5	BGP10	PILOT ASM. HW.	ALL	55	ECF03	3 AMP BREAKERS	HN30005E4H
6	DP012	PLUG 3/4" STEEL COUNTER SINK HO.	ALL	56	EWB72	ELECTRICAL BOX 10 X 8 X 6 HINGED	ALL
7	DGN18	NIPPLE 3/4" X 8" BLACK SCH 40	ALL	57	EHN22	HN COMBO BOX HN20005E2H (2003)	HN20004E2C,HN20005E2H
8	DGT12	TEE 3/4" BLACK	ALL		EHN40	HN COMBO BOX HN30005E4H (2003)	HN30005E4H
9	DGN00	NIPPLE 3/4" CLOSE BLACK	ALL		EHN35	HN COMBO BOX HN30005E3H (2003)	HN30005E3H
10	DGL12	ELBOW 3/4" BLACK PIPE	ALL	58	HNG46	HN CONTROL PANEL CUT GROUP-PRO	ALL
11	HNG49	HN CIL WRAP ASM (2003)	ALL	59	BGG15	IGNITION MODULE HW 90 SECOND	ALL
12	BC780	COIL 7PK SCH 20IN VERTICAL	ALL	60	EA053	STARTER 230V 3PH 17-25 AMP	HN30005E3H
13	BN053	INSUL BLKT 50SQ' 1/2 X 24 8# 25'	ALL		ECC21	CONTACTOR 40AMP 240V 3 POLE DEF	HN20005E2H & E2C
14	HHN27	HN INSULATION RETAINING RING	ALL	61	EFB02	FUSE BLOCK 2 POLE MINI FUSE	ALL
15	BN053	INSUL BLKT 50SQ' 1/2 X 24 8# 25'	ALL	62	EF008	1/8 AMP MINI DELAY FUSE	HN30005E4H
16	HNG28	HN COIL CAP ASM	ALL		EF025	1/4 AMP MINI DELAY FUSE	HN20004E2C,HN20005E2H,HN30005E3H
17	BC787	COIL ASM 7PK 20in (2003 MODELS)	ALL	63	GLL94	LABLE CON BOX HN 5MIL 9.25 X 7	ALL
18	BC855	BURNER NIPPLE; 1/2" X 5.5" SCH 80	ALL	64	EC421	ROCKER SWITCH 230V CLEAR SPST	ALL
19	UP137	PRESSURE RELIEF 3700PSI BLACK	HN30005E3H & E4H	65	EC406	ROCKER SWITCH 24V RED SPST	ALL
	UP128	PRESSURE RELIEF 2800PSI BLUE	HN20004E2C, HN20005E2H	66	ECH70	KNOB; BLUE .25id X 1.50od	ALL
20	DA086	BUSHING 1/2 X 3/8 STEEL	ALL	67	WT040	TANK; FLOAT 4 GAL HD LINEAR	ALL
21	DE088	TEE 1/2" STEEL A105 FORGED	ALL	68	VF050	STRAINER TUBE FOR FLOAT TANK	ALL
22	DE568	SWIVEL 3/8F X 1/2M STEEL	ALL	69	DFF10	WATER TANK BUSHING 5/8"	ALL
23	UPB10	BURST DISC 5000PSI TORQUE 32-4	ALL	70	DQF10	DISCONNECT BARB/TANK FITTING	ALL
24	UPB05	ADAPTER FITTING-BURST DISC	ALL	71	DFF04	FUEL TANK BUSHING 1/4"	ALL
25	DE568	SWIVEL 3/8F X 1/2M STEEL	ALL	72	DFF04	FUEL TANK ELL 1/4"	ALL
26	HHA01	HEX MANI OUTLET 1/2" X 1/2" X REEL	ALL	73	ECH50	THERMOSTAT;60-250 1 GP PART=25	ALL
27	D1082	PLUG 1/2" FLUSH HEAD HEX SOCKET	ALL	74	HLB09	GROMET NOZZLE HOLDER	ALL
28	D1061	PLUG 3/8" FLUSH HEAD HEX SOCKET	ALL	75	NQ550	NOZZLE/QDC 055 X 0	HN30005E3H & E4H,HN20004E2C
29	BC835	BURNER NIPPLE; 1/2" X 3.5" SCH 80	ALL		NQ650	NOZZLE/QDC 065 X 0	HN20005E2H
30	DH026	HOSE 3/8" X 26.5 5000PSI	ALL	76	NQ552	NOZZLE/QDC 055 X 15	HN30005E3H & E4H,HN20004E2C
31	DC568	STREET ELL 3/8 STEEL	ALL		NQ652	NOZZLE/QDC 065 X 15	HN20005E2H
32	UU371	UNLOADER 3-5 @ 3500 K7-1	ALL	77	NQ554	NOZZLE/QDC 055 X 40	HN30005E3H & E4H, HN20004E2C
33	VS030	PRESSURE SWITCH 4000 PA/PR16]	ALL		NQ654	NOZZLE/QDC 065 X 40	HN20005E2H
34	DE866	SWIVEL 3/8F X 3/8M 90	ALL	78	NQ453	NOZZLE/QDC 045 X 25	HN30005E3H & E4H,HN20004E2C
35	DB506	NIPPLE 3/8 STEEL	ALL		NQ553	NOZZLE/QDC 055 X 25	HN20005E2H
36	D8046	HOSE BARB 1/4H X 3/8 P	ALL	79	ECH72	KNOB; RED .25id X 1.50 od	ALL
37	PH406	PUMP 4@ 4000 DUAL 4.8@3000 SHAFT 24MM	HN20005E2C,HN30005E3H & E4H	80	BGT10	TRANSFORMER 120/230-24V 40VA**	ALL
	P4022	PUMP 3CP1120 4 @ 2200 SHAFT 16	HN20004E2C	81	VVC10	CHEMICAL MET VALVE MV-100 MOD.	ALL
38	D6588	STREET TEE 1/2" BRASS	ALL	82	VVF08	FLOAT VALVE 3/8 BRASS	ALL
39	VBC00	CHECK VALVE ASSEM. BYPASS COO	ALL	83	D7520	PANEL FITTING 3/4" BRASS	ALL
41	D8040	HOSE BARB 1/4" 90 ELBOW	ALL	84	FW700	WASHER LOCK 1" GALV***	ALL
42	HHA05	MINI MANIFOLD BRASS 1/2"M X 1/4	ALL	85	D0010	SPRING GARDEN H A	ALL
43	D1040	PLUG 1/4" BRASS	ALL	86	D006M	GARDEN H A 3/8 NPT MALE	ALL
44	D8044	HOSE BARB; 1/4" BRASS* .312 T	ALL	87	D0021	SCREEN WASHER GARDEN H A	ALL
45	D8076	HOSE BARB 5/8HX X 1/2" M .399id PNK	HN20005E2H,HN30005E3H & E4H	88	BGV07	NATURAL GAS VALVE 3/4"	ALL
	D8074	HOSE BARB 5/8HX X 1/2" M .322id BRN	HN20004E2C	89	DGT12	TEE 3/4" BLACK	ALL
46	HPR60	PUMP RAIL BOLT	ALL	90	FB990	U BOLT 1/4"-20 X 13/4"	ALL
47	HHD03	HD PUMP SUPPORT RAIL 14 GA SS	HN20004E2C	91	DGN05	NIPPLE 3/4" X 2 1/2" BLACK	ALL
	HPR10	PUMP ANGLE RAIL AR 4000	HN20005E2H,HN30005E3H & E4H	92	DGN10	NIPPLE 3/4" X 3 1/2" BLACK	ALL
48	ME903	MOTOR 10hp 1750rpm 200-230/460	HN30005E3H & E4H	93	DGCP2	PIPE CAP 3/4" BLACK	ALL
	ME606	MOTOR 6.5hp 230 1PH 3450 MT 3	HN20005E2H	94	GLL95	LABEL PRO LINE 3.125 X 21.875	ALL
	ME504	MOTOR 5hp 208/230v 1PH 3450rpm	HN20004E2C	95	HNG47	HN SWING UP COVER-(2003)	ALL
49	KT080	SHEAVE BK80H	HN20004E2C, HN20005E2H	96	VG200	TRIGGER GUN, INSULATED 4000PSI	ALL
	KU050	SHEAVE 2BK50H	HN30005E3H & E4H	97	DQ74T	M22 TWIST COUPLER 1/4" MALE	ALL
50	KY040	SHEAVE BK40H	HN20005E2H	98	DQ74F	TWIST COUPLER 1/4" PLUG FEM-sut	ALL
	KT036	SHEAVE BK36H	HN20004E2C	99	VW045	WAND 1/4" X 48" MOLDED GRIP	ALL
	KU050	SHEAVE 2BK50H	HN30005E3H & E4H	100	DQ04S	COUPLER 1/4" SOCK FEM	ALL
51	KSH19	BUSHING H24MM	HN20005E2H,HN30005E3H & E4H	101	AVGH2	GUN/WAND 48" MOULDED INSULATED	ALL
	KHS15	BUSHING Hx16.5MM	HN20004E2C	102	DH060	HOSE 3/8" X 50' BLU/GRY 25	ALL
52	KSH20	BUSHING HX 1/38 5/16	HN30005E3H & E4H	103	HNG31	HN PILOT SHEILD STAINLESS	ALL
	KSH12	BUSHING H 3/4	HN20004E2C, HN20005E2H	104	HNG32	HN PILOT BRACKET STAINLESS	ALL
				105	ECH75	HEAVY DUTY BEND RESTICTOR-B	ALL
					BGV05	NG TO LP COVERSON INSTALL 440K	ALL